



JML  Garden Rooms

jmlgardenrooms.co.uk



ABOUT US

WE CREATE SUSTAINABLE SPACES TO LIVE, WORK AND PLAY.

As part of the JML Group, we have over 25 years' experience in the building industry and have become a leading expert in SIPs construction techniques in Scotland. We've applied our unique knowledge to create a range of luxury Garden Rooms that are perfect for any use – why not come and see for yourself? We're based in Perthshire and at our showrooms set in the glorious Ochil Hills you'll be able to experience the benefits of a JML Garden Room for yourself.



"JML GARDEN ROOMS RECENTLY DESIGNED AND CONSTRUCTED AN ECO THEMED GARDEN ROOM OFFICE AT MY HOME IN FIFE, SCOTLAND. THE ENTIRE TEAM WERE VERY PROFESSIONAL, FRIENDLY, COMMUNICATIVE AND CREATIVE. I WOULD HIGHLY RECOMMEND JML GARDEN ROOMS TO OTHER POTENTIAL CUSTOMERS."

N. BIRNIE, FIFE

WHAT ARE JML GARDEN ROOMS?

MAKING THE MOST OF YOUR GARDEN SPACE.

How would you like to enjoy your garden space all year round, rain or shine? With our beautiful, luxurious Garden Rooms you can transform your living space, bringing the great outdoors indoors. Our Garden Rooms are built to last; constructed from hi-tech Structural Insulated Panels (SIPs) that offer unrivalled ecological efficiency and sound proofing. They are quick to erect, with minimal disruption to your home. Our panels can even be carried through your home if back garden access is tricky. Also, most don't require planning permission.

AJML Garden Room has many flexible uses: stylish office, gym, art studio, guest room, playroom, games room, therapy space, sales office, library, garden annexe, music room – the list is endless. On the commercial front, they are also popular for school classrooms, children's nurseries and music and therapy rooms for businesses.





OUR SERVICES

ALL JML GARDEN ROOMS COME WITH PEACE OF MIND - A 10-YEAR STRUCTURAL GUARANTEE.

Our exceptional customer service comes as standard, as does our flexible approach to ensure we design and build your perfect Garden Room. Depending on size and specification, we could be handing over the keys to your new Garden Room in just two weeks.

We can project manage the whole JML Garden Room building process for you, from the groundworks to electrics, lighting, flooring, decking and other extras, such as phone lines, plumbing, and high-speed cabling. For those looking for something more technically sophisticated, we have partnerships with brilliant media, lighting, interior design and paint finishing specialists who are all leading experts in their fields.



OUR RANGE

A DESIGN FOR EVERYONE.

Our range of contemporary (Lowlander) and traditional (Highlander) Garden Rooms are available in various sizes, all of which are within permitted development guidelines and can be adapted with personal touches to meet your needs. Or for even more space, our Garden Annexes offer a great alternative to extending your property. New to our range we have the Hideout.... perfect for cosy evenings entertaining friends and family.

Got your own ideas? We can also design and build something completely bespoke to exactly match your brief and budget. We've been in the building trade a long time, so we know what works and have a specialist architect on hand to help create your dream space.



HIGHLANDER



LOWLANDER



GARDEN ANNEXE



OFFICE POD



LOWLANDER

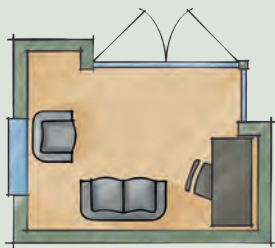

LOWLANDER 1
INTERNAL AREA - 3.6M X 2.8M

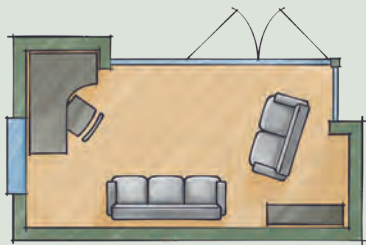

LOWLANDER 2
INTERNAL AREA - 5.1M X 2.8M

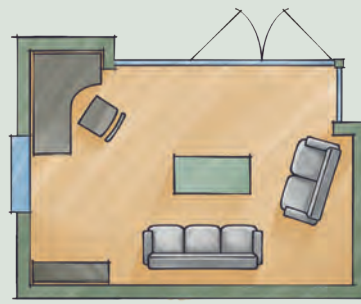

LOWLANDER 3
INTERNAL AREA - 5.1M X 3.7M

(please note the floorplans above are not to scale and all sizes are approximate)





HIGHLANDER

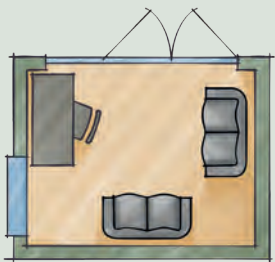

HIGHLANDER 1
INTERNAL AREA - 3.5M X 2.7M

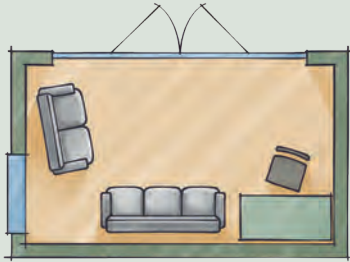

HIGHLANDER 2
INTERNAL AREA - 4.7M X 2.7M

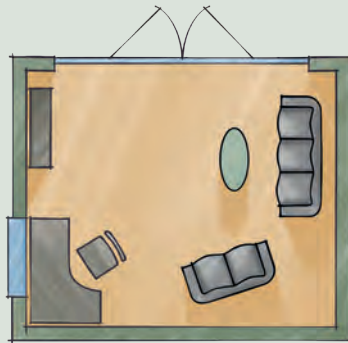

HIGHLANDER 3
INTERNAL AREA - 4.7M X 3.9M

(please note the floorplans above are not to scale and all sizes are approximate)





THE HIDEOUT

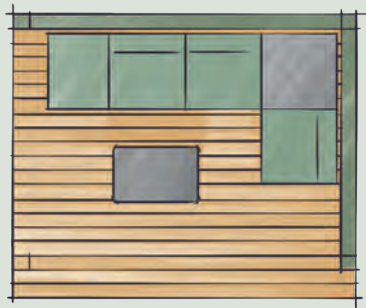

HIDEOUT
INTERNAL AREA - 3.0M X 3.6M

- Our Hideouts can be one, two or three sided to suit any location
- With or without a deck so if you already have a patio it can provide an ideal covered area
- Size can be modified to suit specific garden space
- Range of colour finishes to choose from
- Electric connection can be accommodated for lighting, power and outdoor heating
- Ideal outdoor covered area for entertaining, lounging, hot tub, play space and outdoor kitchen - all to enjoy in our unpredictable weather!



(please note the floorplans above are not to scale and all sizes are approximate)



GARDEN ANNEXES

MORE THAN A ROOM.

A Garden Annexe offers a wealth of opportunities and can be the ideal solution for a relative who wants to keep their independence and privacy, but would benefit from the security of being close to their family. It can be as simple as a single room with living and/or sleeping space or we can create a fully fitted annexe with a separate living room, bathroom, fitted kitchen and bedroom, or indeed more bedrooms if required.

Our in-house design service allows you to sit down and discuss your own specific requirements and help create a space which works for you and your family. We provide a full turn-key service meaning our team will handle everything throughout the process, from the initial meeting to handing over your keys.

Our JML Garden Annexes are built using the same high quality materials and finishes as our Garden Rooms, ensuring you have a sound investment and a beautiful, sustainable annexe, built to last.

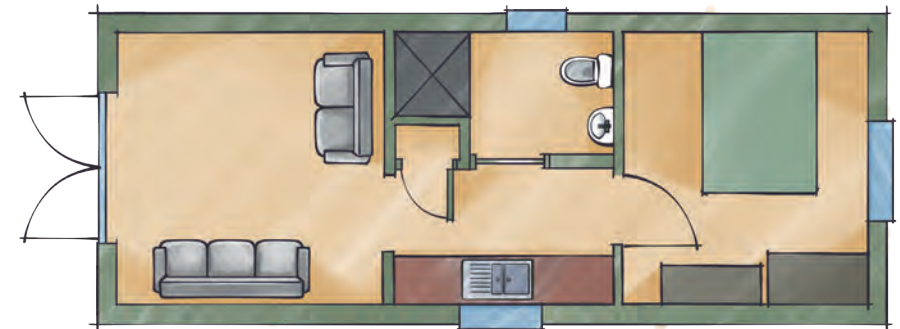

GARDEN ANNEXE
INTERNAL AREA - 8.9M X 3.2M

(please note the floorplans above are not to scale and all sizes are approximate)

OFFICE PODS

WORK LIFE BALANCE.

There are many benefits to working at home – not least the savings on cost and travel, the flexible hours and the ability to maximise family time – but doing business in the family home can bring its own distractions. Our Office Pods offer the best of both worlds – separated from the main house, they offer a quiet, secluded work environment (with all the tech comforts you need) that frees up valuable space in the home.

Available in two standard sizes (the biggest being large enough for two people to work in simultaneously), whichever you choose, it will become an office you will be keen to escape to! Our office spaces have been designed to accommodate an Ikea desk unit or a more premium range, so it is practical on every level and can be fully furnished ready for you to start work. Our IT specialist can advise you on the best products to suit your media and communication needs and lighting, security and heating systems – all of which can be controlled remotely.

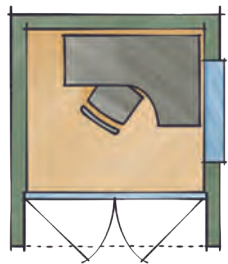

OFFICE POD 1
INTERNAL AREA - 2.11M X 2.01M

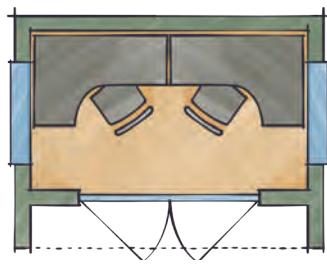

OFFICE POD 2
INTERNAL AREA - 3.31M X 2.01M



(please note the floorplans above are not to scale and all sizes are approximate)



OUTDOOR CLASSROOMS

SPACE TO LEARN.

Whether your educational establishment needs an extra classroom, staff room, hall, nursery area or music room, we have the experience and designs to make it a reality. With our background in construction, our skills meet the unique requirements of the education sector, tailoring the size of our buildings as required and also the placement of glazing and services such as water and electricity. We also ensure that any disruption to your school during construction is minimised – we manufacture off-site so that on-site construction is quick and can be scheduled to make the most of quiet school periods and holidays.

The multi-functional nature of our buildings ensures they can be used for different purposes throughout the year, while remaining cheap to run due to their exceptionally high thermal properties.

COMMERCIAL SPACES

WORKING FOR YOU.

Whatever your business requirement, a JML Garden Room fits the bill. All models in our range are suitable for commercial use as corporate offices, additional meeting rooms, professional therapy spaces, music teaching rooms (SIPs are fantastic for acoustics and sound proofing), classrooms, gyms and much more besides.

We appreciate how precious your time is, so we provide a full service, liaising with the architect and planning and building control departments so that the whole process runs as smoothly as possible whilst maintaining the highest quality finish.



JML TESTIMONIALS

“I am the proud owner of a JML Garden Room and I use the space for my art studio, which has also been hijacked for studying. Having fitted a television and internet, it has become a truly purposeful room that all the family can enjoy. The tradesmen are first class and their attention to detail is commendable. I thoroughly enjoyed working with JML and all decisions were always discussed with ourselves before proceeding with the work. JML gave us the step by step assurance that we were getting exactly what we wanted. I can highly recommend this company for being accurate with cost, great craftsmanship, attention to detail and for the personal touch.”

K. SOMMERVILLE, AUCHTERARDER

“The JML team were extremely friendly and professional. From our very first showroom visit to the final installation on Skye, their advice and guidance was excellent. The work ethics, speed and skills of the team of builders on site was astonishing. The end result is no less than a dream come true - we cannot recommend highly enough.”

P. MURRAY, ISLE OF SKYE

“I met John Langley and the architect and I was confident that they would provide me with a great Garden Annexe and within a fairly short timescale. They started on time and finished on time and the building is of the highest quality both in workmanship and fittings. Thank you JML Garden Rooms.”

L. BURNS, ABERDEENSHIRE

JML  Garden Rooms
— LIVE · WORK · PLAY —

The Arns, Auchterarder, Perthshire PH3 1EJ

Email: info@jmlgardenrooms.co.uk

Tel: 01764 663 668

jmlgardenrooms.co.uk

IMPORTANT NOTICE TO CUSTOMERS

The information contained within this document is indicative and is intended to act as a guide only as to the finished product.

JML Garden Rooms operates a policy of continual product development and therefore the specifications outlined in this brochure may vary from those provided. Floor plans, dimensions and specifications are correct at time of going to press.